

PX940 High Performance Industrial Printer - Configuration Guide

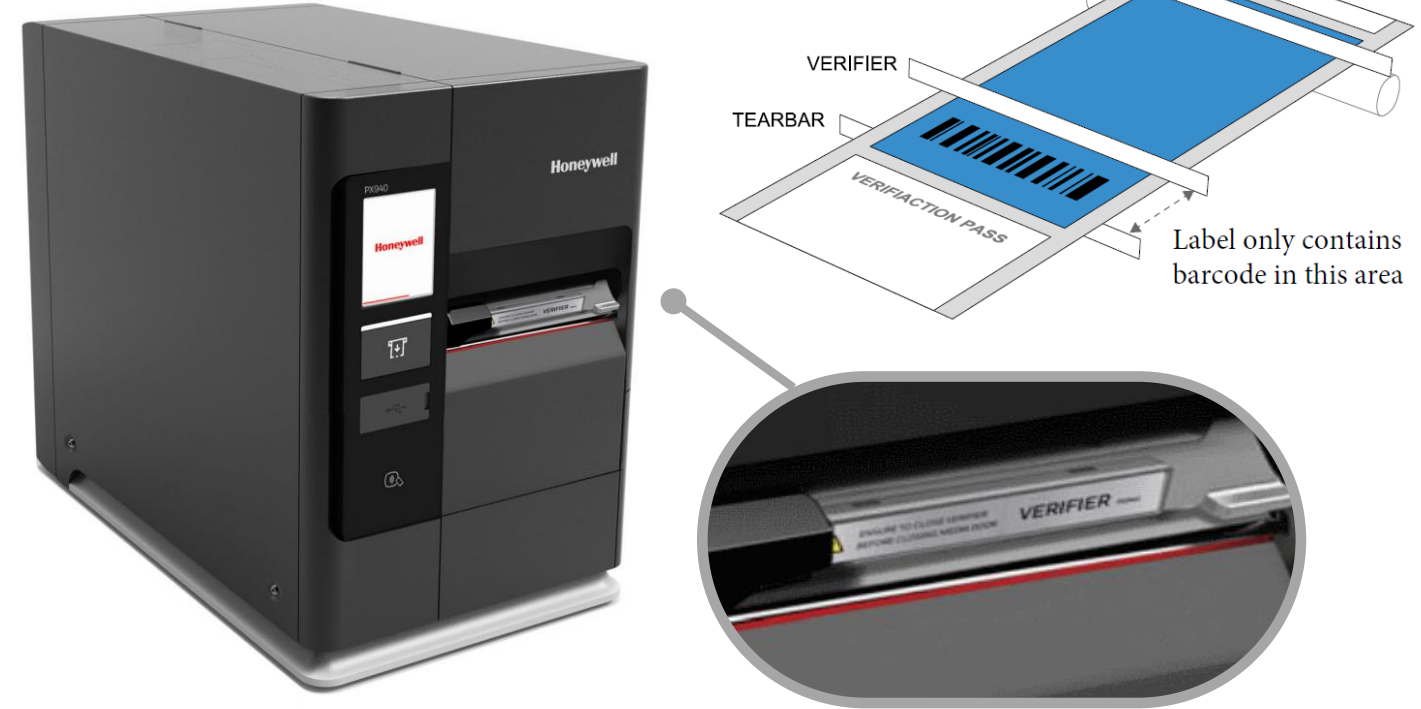

PX940A
without verification technology



PX940V
with verification technology

PX940A without Verifier – 203DPI

PX940A00100060200 PX940A, Full Touch Display, Universal firmware, Ethernet, USB, Serial, Low Power Bluetooth, Ribbon Ink IN/OUT, Internal Rewinder, Peel Off, Label Taken Sensor, Media Core 3 inch, Direct Thermal and Thermal Transfer, 203DPI, No Power Cord

PX940A without Verifier – 300DPI

PX940A00100060300 PX940A, Full Touch Display, Universal firmware, Ethernet, USB, Serial, Low Power Bluetooth, Ribbon Ink IN/OUT, Internal Rewinder, Peel Off, Label Taken Sensor, Media Core 3 inch, Direct Thermal and Thermal Transfer, 300DPI, No Power Cord

PX940A without Verifier – 600DPI

PX940A00100060600 PX940A, Full Touch Display, Universal firmware, Ethernet, USB, Serial, Low Power Bluetooth, Ribbon Ink IN/OUT, Internal Rewinder, Peel Off, Label Taken Sensor, Media Core 3 inch, Direct Thermal and Thermal Transfer, 600DPI, No Power Cord

PX940V with Integrated Verifier – 203DPI

PX940V30100060200 PX940V, Verifier with Perpetual license, Full Touch Display, Universal firmware, Ethernet, USB, Serial, Low Power Bluetooth, Ribbon Ink IN/OUT, Internal Rewinder, Peel Off, Label Taken Sensor, Media Core 3 inch, Direct Thermal and Thermal Transfer, 203DPI, No Power Cord

PX940V with Integrated Verifier – 300DPI

PX940A00100060300 PX940V, Verifier with Perpetual license, Full Touch Display, Universal firmware, Ethernet, USB, Serial, Low Power Bluetooth, Ribbon Ink IN/OUT, Internal Rewinder, Peel Off, Label Taken Sensor, Media Core 3 inch, Direct Thermal and Thermal Transfer, 300DPI, No Power Cord

PX940V with Integrated Verifier – 600DPI

PX940A00100060600 PX940V, Verifier with Perpetual license, Full Touch Display, Universal firmware, Ethernet, USB, Serial, Low Power Bluetooth, Ribbon Ink IN/OUT, Internal Rewinder, Peel Off, Label Taken Sensor, Media Core 3 inch, Direct Thermal and Thermal Transfer, 600DPI, No Power Cord

Honeywell Repair Services

SVCPX940-5FC3 PX940, PLUS, 5 Day Turnaround, 3 Year, Day One

PX940 High Performance Industrial Printer - Configuration Map

Version	Firmware	Language UI Settings	Connectivity	I/O Option	Ribbon Ink In/Out	Media Option	Media Core	Print Option	Custom	Description	Notes
PX940											
A0										PR (without verifier)	
V3										Verifier + Perpetual License	Linear (1D) barcode verification conforming to ISO/IEC 15146-2016 2-Dimensional (2D) barcode verification conforming to ISO/IEC 15415-2011 Read/No Read Barcode verification
	0									Universal Firmware	Fingerprint (FP), Direct Protocol (DP), Intermec Printer Language (IPL) support on 203 dpi and 300 dpi only, ZSim2 (ZPL-II), Datamax Printer Language (DPL), XML enabled for SAP® All and Oracle®, WMS
		0								Display font (Simplified Chinese)	
		1								Display font (Rest Of World)	
			0							USB + Serial + Ethernet + Bluetooth	
			1							USB + Serial + Ethernet + Bluetooth + Wi-Fi (NA)	Available as kit – Part# 50151892-001, KIT Wireless LAN (NA)
			2							USB + Serial + Ethernet + Bluetooth + Wi-Fi (ROW)	Available as kit – Part# 50151893-001, KIT Wireless LAN (ROW)
				0						None	
				1						Parallel	Available as kit – Part# 50151883-001, KIT, Parallel Port
					0					Ink Out (Default)	
					0					None	
					6					Rewinder, Peel Off + Label Taken Sensor (LTS)	
						0				3-inch Core	
						1				1.5-inch Core	
							20			203 DPI	Available as kit – Part# 50151886-001, KIT, Print head 203DPI PX940
							30			300 DPI	Available as kit – Part# 50151887-001, KIT, Print head 300DPI PX940
							60			600 DPI	Available as kit – Part# 50151888-001, KIT, Print head 600DPI PX940
								0		No Power Cord	
								1		China	
								2		USA, Vietnam (Type B)	
								3		EU, Korea, Thailand, CSAR (Type F)	
								4		UK, Malaysia, Singapore (Type G)	
								5		India (Type D)	
								6		Australia, New Zealand (Type I)	
								9		Taiwan	



Honeywell Repair Services

PX940 – Repair Services

For Best-In-Class Service

With Honeywell Repair Services, it’s easy to get the level of repair coverage and protection that makes the most sense for your business. And our repair services are now available in over 70 countries with global pricing and global standards of quality.

Choose from one of our new cost-effective Repair Service contract programs – Complete, Plus or Basic – to get the right amount of coverage and protection you need for your durable, rugged and ultra-rugged products. And for equipment not covered by a contract service plan, you can choose from our Non-Contract Repair Service offerings, which include flat-rate repairs, time-and-materials repairs and more.

Ensure business continuity, workflow performance and protection of your technology investments with Honeywell Repair Services.

Plus Repair Services

Protect your technology investment! With Honeywell’s 3 and 5 year Plus comprehensive repair services plan, you won’t incur any additional costs beyond the plan enrollment for service on covered devices and eligible accessories included with equipment sent to the depot for service. Eligible accessories include damaged styluses, battery-door covers, screen protectors, hand straps and clips.

Service Overview

- Features and benefits include:
 - Comprehensive coverage – including device replacement for rugged or stationary products
 - Day One multi-year pricing for lower annualized costs
 - Three years of locked-in service-price protection, with optional renewals
 - Options for 2-day and 5-day service levels
 - Cleaning and preventive maintenance
 - Telephone-based technical support
 - Convenient online Return Authorization requests and access to online service-history reports

Complete Repair Services

The only contract you will ever need! With Honeywell’s 3 and 5 year Complete comprehensive repair services plan, one contract covers it all – device, power management and accessories. Eligible accessories and power management for mobile computers include: batteries, docks, chargers, cradles, cables, damaged styluses, battery-door covers, screen protectors, hand straps and clips.

Service Overview

- Features and benefits include:
 - Comprehensive coverage – including device replacement for rugged or stationary products
 - Coverage for power management and select accessories
 - Day One multi-year pricing for lower annualized costs
 - Five years of locked-in service-price protection
 - Options for overnight and 2-day or 5-day service levels
 - Cleaning and preventive maintenance
 - Telephone-based technical support
 - Convenient online Return Authorization requests and access to online service-history reports

Part#	Description
SVCPX940-5FC3	PX940, PLUS, 5 Day Turnaround, 3 Year Day One
SVCPX940-5FC5	PX940, PLUS, 5 Day Turnaround, 5 Year, Day One
SVCPX940-2FC3	PX940, PLUS, 2 Day Turnaround, 3 Year, Day One
SVCPX940-2FC5	PX940, PLUS, 2 Day Turnaround, 5 Year, Day One

Part#	Description
SVCPX940-5PS3	PX940, COMPLETE, 5 Day Turnaround, 3 Year, Day One Includes 1 Printhead, Platen Rollers and Replacement Printers (APAC Only)
SVCCPX940-2PS5	PX940, COMPLETE, 2 Day Turnaround, 5 Year, Day One Includes 2 Printheads, Platen Rollers and Replacement Printers

Honeywell Repair Services

PX940 – Repair Services

For Best-In-Class Service

PX940



Warranty Cover Against Product Defect

BASIC Service

Comprehensive Coverage:

- Device Replacement
- Accidental Damage
- Wear & Tear

Includes Replacement of:

- Platen Roller



PLUS Service

Complete Coverage

- Limited Printhead Replacement
- Operational Intelligence
- Accidental Damage
- Device Replacement
- Wear & Tear



Printhead
(3 Year – 1 Printhead Replacement)
(5 Year – 2 Printhead Replacement)

COMPLETE Service

Part#	Description
SVCPX940-EXW2	PX940, BASIC, 10-15 Day Turnaround, 2 Years (1 Year Factory Warranty + 1 Year Extended)
SVCPX940-5FC3	PX940, PLUS, 5 Day Turnaround, 3 Year Day One
SVCPX940-5PS3	PX940, COMPLETE, 5 Day Turnaround, 3 Year, Day One Includes 1 Printhead, Platen Rollers and Replacement Printers

PX940 High Performance Industrial Printer

PX940 – Connectivity

Expand your I/O with additional cards.

Part#	Description
50151892-001	KIT, WIRELESS LAN PX940A/PX940V - North America (NA)
50151893-001	KIT, WIRELESS LAN PX940A/PX940V – Europe (EU)

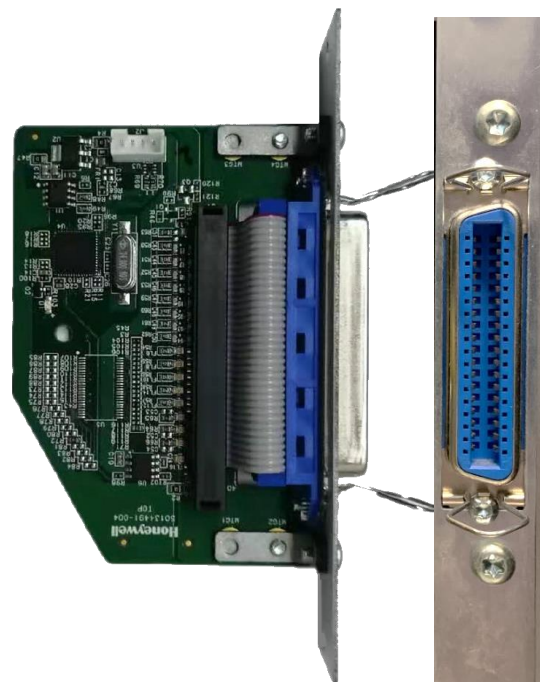

Part#	Description
50151883-001	KIT, PARALLEL PORT
(Adds IEEE1284 Parallel Port)	
Use with Part# 1-974022-018 Parallel Cable	

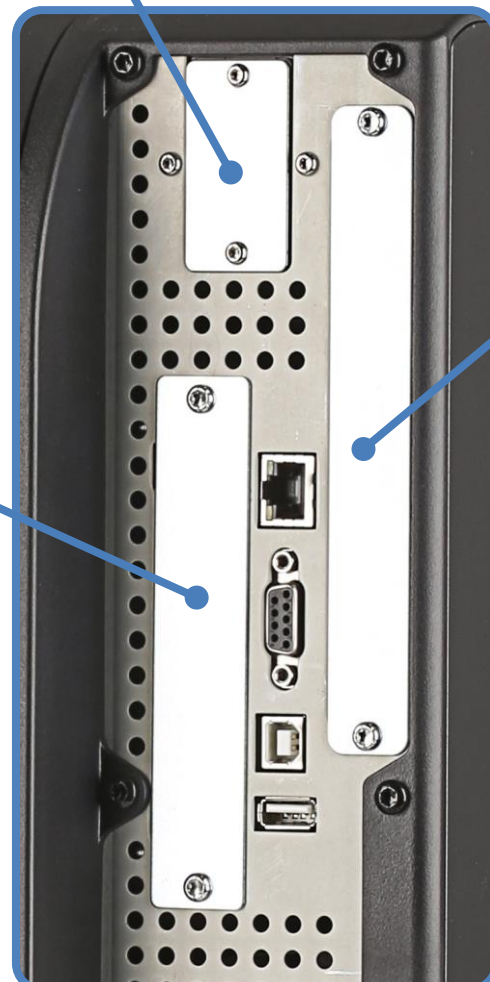

Part#	Description
50151885-001	Applicator Interface Card

This option board contains 4 connectors for a Z-Style Port (D-Sub 15-pin), an S-Style Port (SCSI 14 Pin), an External Power Port (Mini-DIN 6-Pin), and an External Error Port (Mini-DIN 8-Pin).

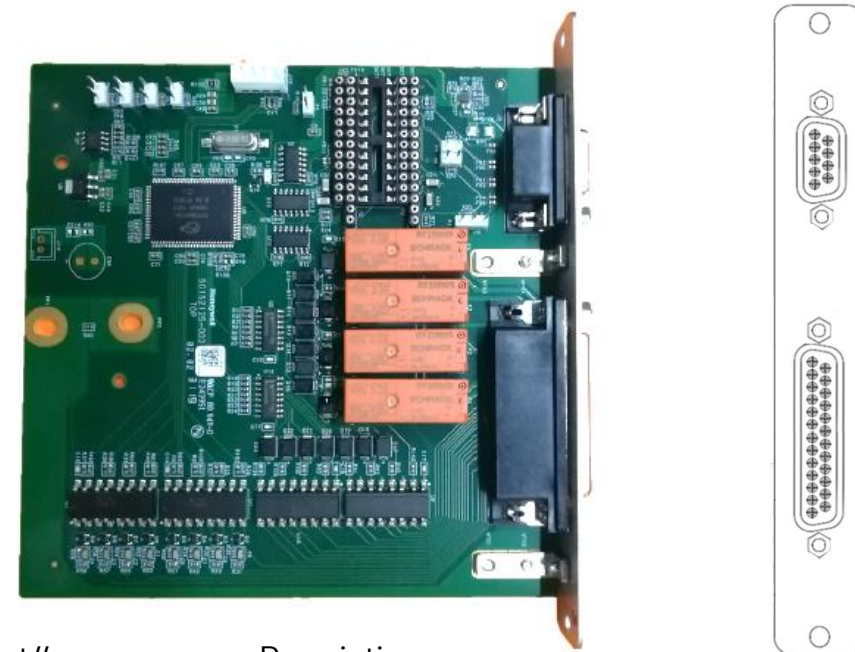

Part#	Description
50151884-001	UART Industrial Interface Card
(Adds DB25 Industrial Interface for controlling I/O and DB9 Serial port)	

PX940 High Performance Industrial Printer

PX940 – Accessories

The PX940 auto detects the printhead, therefore you can simply swap between 203, 300 and 600dpi *



Part#	Description
50151886-001	KIT, PRINthead 203DPI, PX940
50151887-001	KIT, PRINthead 300DPI, PX940
50151888-001	KIT, PRINthead 600DPI, PX940



Part#	Description
50151881-001	KIT, PLATEN ROLLER, PX940



Part#	Description
1-110501-00	Cleaning Card, 4.5"x6", box of 25

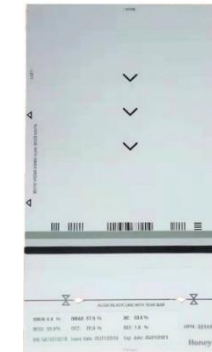

Part#	Description
50144663-001	KIT, Verifier Calibration Card, PX940V



Part#	Description
321-576-004	USB (USB-A to USB-B) cable, 6.5 ft. (2 m) length



Part#	Description
1-974024-018	RS-232 (DB9F to DB9M) cable, 5.9 ft. (1.8 m) length



Part#	Description
1-974022-018	Parallel (IEEE 1284) cable, 5.9 ft. (1.8 m) length

* Please refer to Thermal Printhead Installation Instructions on how to change the printhead.

PX940 High Performance Industrial Printer

PX940 – Printing Options

See below the different printing options available:

Tear Off

Most commonly used, print any number of labels and simply tear the labels off from the printer at the end of the print job.

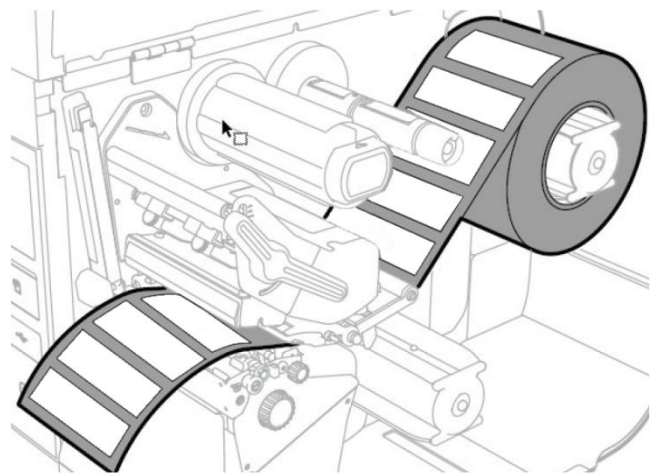

Peel and Present

Peels the label from the liner as it is printed and presents the label to the user one a time. Printing is halted after each label until the user remove the label. Requires Rewinder, Peel Off + Label Taken Sensor (LTS) option.

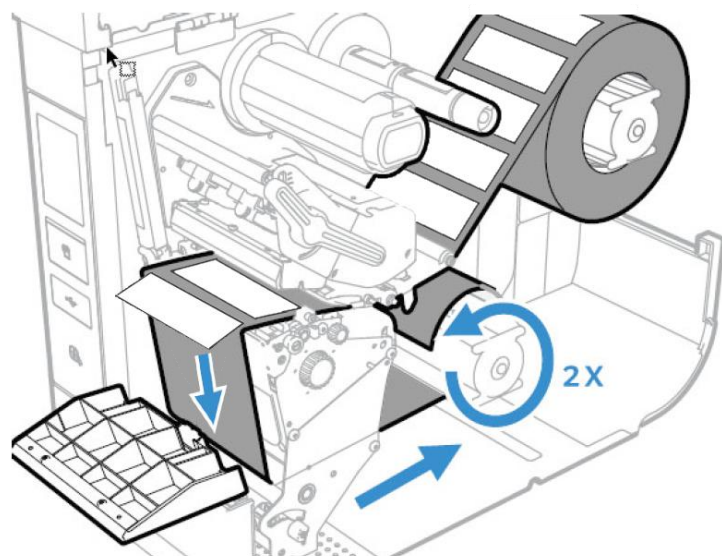

Fan Fold

The media is stacked outside the rear of the PX940, or the bottom access slot.

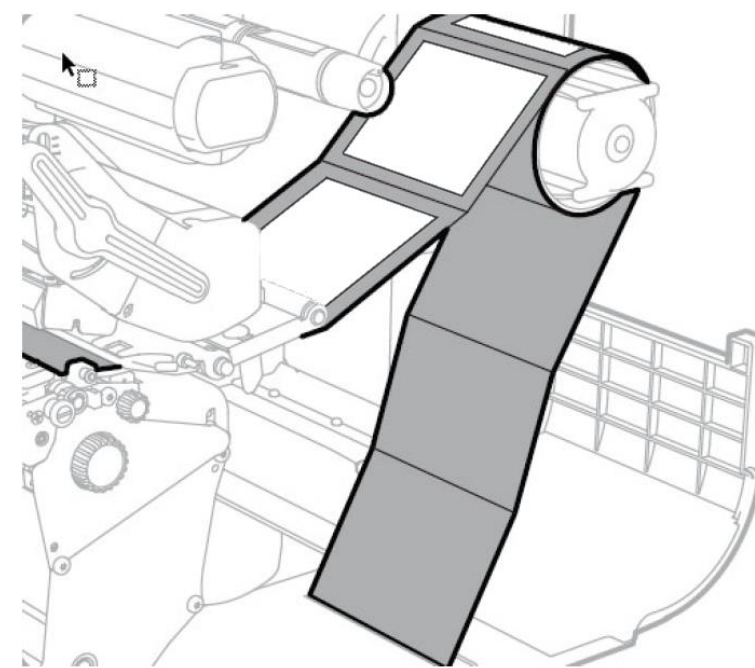
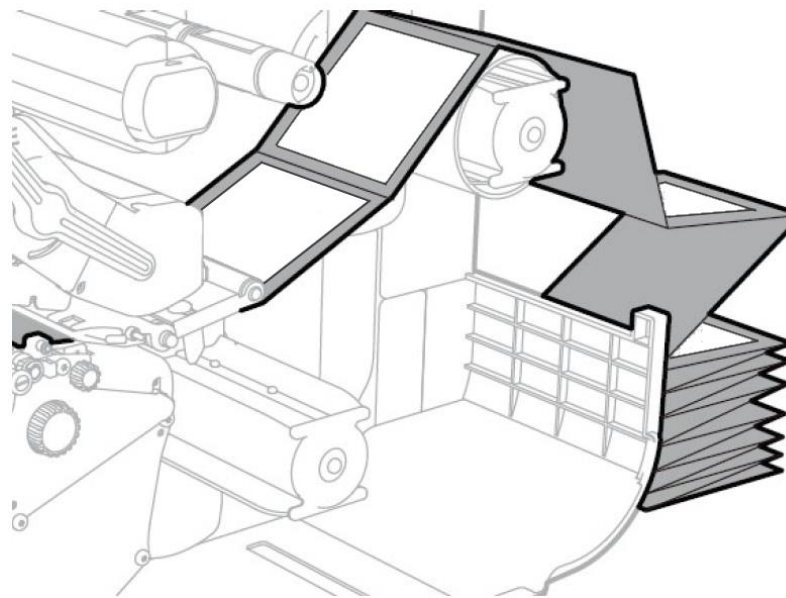

Rewind Printing

Printing and rewinding the media directly onto the rewinder take-up with an empty core installed, useful for batch printing rolls of labels. Requires Rewinder, Peel Off + Label Taken Sensor (LTS) option and Rewinder Batch Plate.

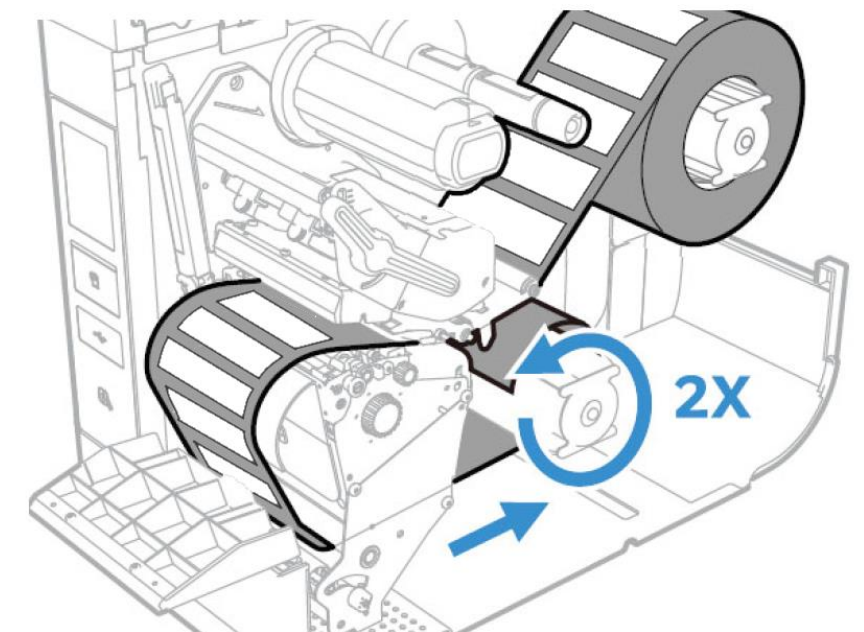
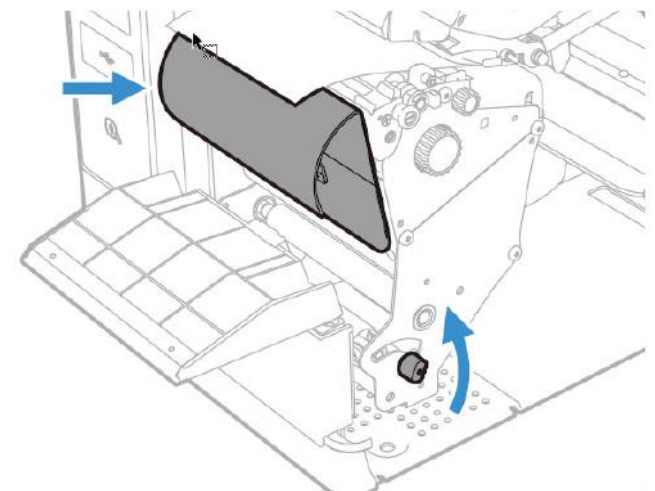

Miscellaneous

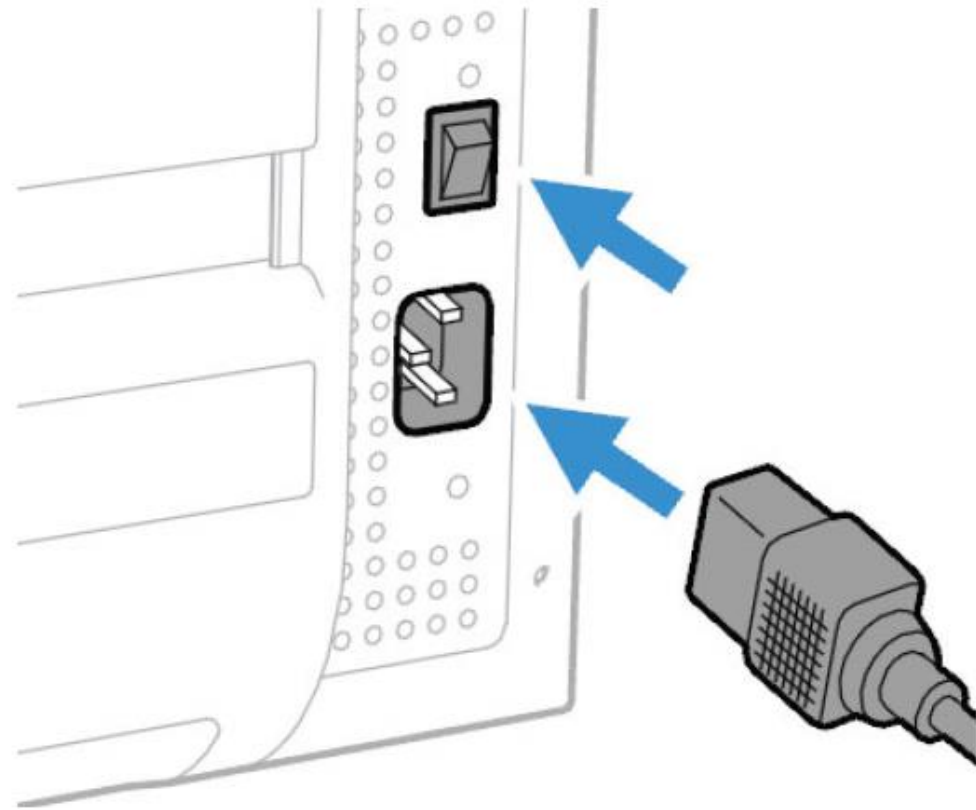

AC Cords

Part Number	Description
50117501-001	AC Power Cord, Australia
19-19807	AC Power Cord, China
9000091CABLE	AC Power Cord, Denmark
77900508E	AC Power Cord, Europe
50127245-001	AC Power Cord, India
9000092CABLE	AC Power Cord, Italy
321-500-002	AC Power Cord, Japan
9000093CABLE	AC Power Cord, Switzerland
77900507E	AC Power Cord, United Kingdom
19-19726	AC Power Cord, United States

Disclaimer

Honeywell International Inc. (“HII”) reserves the right to make changes in specification and other information contained in this document without prior notice, and the reader should in all cases consult HII to determine whether any such changes have been made. The information in this publication does not represent a commitment on the part of HII.

HII shall not be liable for technical or editorial errors or omissions contained herein; nor for incidental or consequential damages resulting the furnishing, performance, or use of this material.

This document contains proprietary information that is protected by copyright. All rights are reserved. No part of this document may be photocopied, reproduced, or translated into another language with-out prior written consent of HII.

Web Address: www.honeywellaidc.com

The Bluetooth trademarks are owned by Bluetooth SIG, Inc., U.S.A and licensed to Honeywell.

Other product names mentioned in the manual may be trademarks of registered trademarks of their respective companies and are the property of their respective owners.

All rights reserved.